

FOR LEASE

KITTERMAN PLAZA

RETAIL SPACE



ADDRESS: 6641 S US Hwy 1; Port Saint Lucie, FL
BUILDING SIZE: 14,540 SF Total
ZONING: Retail
LEASE AMOUNT: \$12.00/SF (NNN)

COMMENTS: Introducing Kitterman Plaza, one of Port Saint Lucie's most progressive retail centers. Located directly on US1 for excellent visibility and access. Kitterman Plaza features; Non combustible tilt-up concrete & steel construction, impact windows, a unit with a drive-thru, grease-traps and excellent signage on building and large sign monument. Come join Hurricane Wings and Teachers Pet at Kitterman Plaza.

Great Lease terms available! Call Derrick Christenson for your private showing.

EXCLUSIVELY LISTED BY...

For Additional Information Contact:

759 S. Federal Highway, Ste. 304
Stuart, Florida 34994
www.ChristensonCommercial.com

**Christenson
Commercial**
REAL ESTATE

Derrick Christenson
Office: (772) 419-5076
Derricksoldit@aol.com

The above information has been obtained from sources we consider reliable, but we do not guarantee it; submitted subject to errors, prior sale, withdrawal, or change in price or terms and conditions without notice.

2) 10' OAK
12' OAK (3) 8' OAK

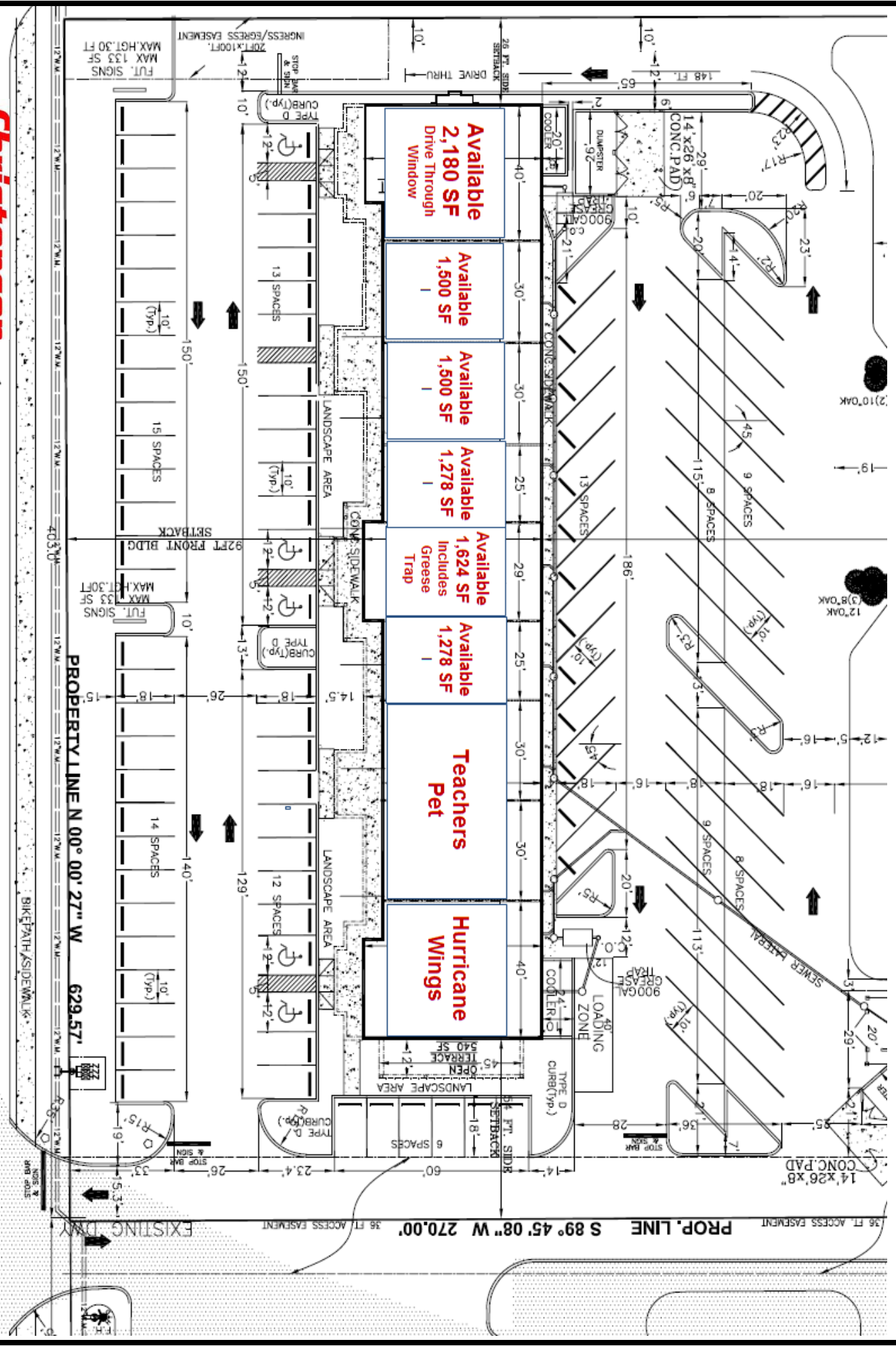

FUT. SIGNS
MAX. HGT. 30 FT
20 FT X 100 FT
INGRESS/EGRESS EASEMENT

PROPERTY LINE N 00° 00' 27" W 629.57'

PROP. LINE S 89° 45' 08" W 270.00' 36 FT ACCESS EASEMENT

BIKE PATH / SIDEWALK

EXISTING DRAIN

Christenson
Commercial
REAL ESTATE

US HIGHWAY NO 1

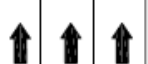



6641 S US Hwy 1
Port Saint Lucie, FL

Christenson
Commercial
REAL ESTATE

759 S. Federal Highway, Ste. 304
Stuart, Florida 34994

www.ChristensonCommercial.com